



# CONFERENCE & FUNCTION CENTRES



## **ABOUT CALOUNDRA CENTRAL**

### **Apartment & Meeting Room Facilities**

Ideal for both Business and Leisure

#### **Perfect Location – Professional Help – Full Catering**

Caloundra Central Apartments Conference rooms are ideal for corporate gatherings, seminars, board meetings & events. Caloundra Central Apartments conference facilities have the flexibility to cater for groups from 2 to 60 people. From a small breakfast meeting to a conference or training seminar, our Executive Meeting Rooms offer the perfect size and location for all requirements. Our professional conference and event management team will assist in ensuring that your event is a great success!

Alternatively, our spacious apartments are ideal for Interviews and Small Group Training

- 1, 2 & 3 Bedroom Apartments including a separate powder room

#### **RESORT FACILITIES**

Lap pool, wading pool & outdoor spa  
Secure undercover car parking  
Room Service  
Onsite Catering

#### **CONFERENCE FACILITIES**

3 Air Conditioned Room  
Accommodate up to 60 delegates  
Fully integrated AV equipment  
Additional Break Out Areas

**Call Our Conference Team to enquire about a special accommodation package for your next meeting now on '1300 783 007'.**

## **“You’re Hospitality Professionals”**

### **Some Information about Central Apartment Group.....**

#### **Caloundra Central....**

Our superbly appointed serviced apartments ensure your Caloundra experience is a stylish and comfortable one. A pleasant 15 minute walk to Dicky Beach or Currimundi Beach, Caloundra Central is situated in what is classed as the gateway to the services and attractions of the Sunshine Coast. The Property boasts key card security system to all areas, Undercover Parking, Internet Kiosk, 2 Outdoor Pools, Spa and BBQ area.

Complete with our renowned personalised service, Caloundra Central is the ideal base for business or leisure.

#### **Our Apartments....**

All of our apartments feature full laundry, complete kitchen facilities and large open plan living areas. The two and three bedroom apartments feature two bathrooms with most of our one bedroom apartments including an additional powder room. All apartments enjoy the comfort of reverse cycle climate control, TV, DVD, Stereo and direct dial phones with voicemail and broadband. Balconies catching the pleasant sea breezes and ocean views are available in most of our apartments. For overnight guests, we also have a number of Studio rooms, motel style featuring tea & coffee making facilities, TV, DVD & Stereo (please note - balcony not available).

#### **Bedding Configuration....**

Studio & One Bedroom Apartments – Queen Bed

Two Bedroom Apartment – Queen / Queen or Queen / 2 Singles

Three Bedroom Apartment – Queen / Queen / 2 Singles

Cots, Sofa Beds & Rollaway Beds also available on request



## Conference Facilities.....

We offer full conference facilities for all small meetings and functions for up to 60 people. We provide full catering and audio visual equipment - everything you need to ensure that your conference or function is successful.

## Technical Requirements.....

Data projector & Screen - \$80 per day

TV \$30 per day

Other technical equipment on application

## Secretarial Services.....

Our friendly Front Office Team are available to carry out all secretarial services when you need them. This includes photocopying, typing, faxing etc...

## Conference Room Layouts & Facilities

**Our resort facilities are just what you need for your next conference, presentation, meeting, cocktail party, product launch, training session or corporate dinner.**

**We offer full catering facilities on site, just ask your friendly conference team for our catering options.**

| Room Name     | Room Size Meters | Ceiling Height | Theatre | Class Room | U - Shape | Banquet | Board Room |
|---------------|------------------|----------------|---------|------------|-----------|---------|------------|
| Nicklin Room  | 10.2mt x 8mt     | 2.4mt          | 60      | 45         | 35        | 50      | 30         |
| Browning Room | 5.5mt x 6mt      | 2.7mt          | 30      | 20         | 15        | 15      | 15         |
| Restaurant    |                  | 2.9mt          | 80      | 50         | 25        | 80      | 30         |

**Ask your contact for conference day package prices including accommodation... from \$109.00 per person!**

**We would like to extend an invitation to you or your local representative to call in and see our facilities and what we have to offer, just call our team at anytime.**

## Browning Room

U Shape A

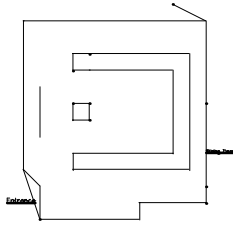

U Shape B

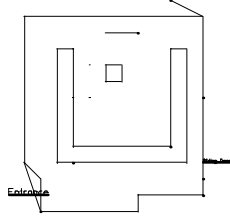

Theatre A

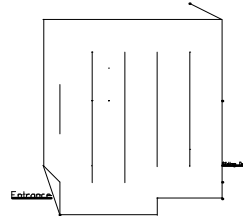

Theatre B

## Nicklin Room

U Shape A

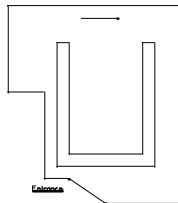

U Shape B

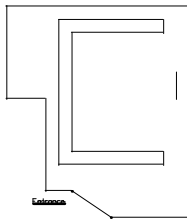

Theatre A

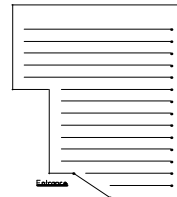

Theatre B

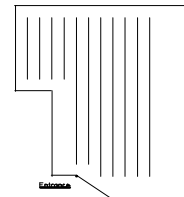

## Contact Details

Corner Nicklin Way & 36 Browning Blvd, Caloundra Queensland 4551

Phone: +61 (0)7 5490 2400 Fax: +61 (0)7 5490 2499

Email: [sue.jackson@caloundracentral.com.au](mailto:sue.jackson@caloundracentral.com.au) Toll: 1300 783 007

# CONFERENCE PACKAGES

## Room Hire

**Inclusions:** Conference room hire, Whiteboard, stationary, mints, Iced water, Flip Chart & paper, Broadband internet Access.

**Nicklin Room \$350 per day**

**Browning Room: \$165 per day**

**Restaurant: \$500 per day** (This room is suitable for parties as well as conferences – Exclusive Use)

## Catering Options per Delegate

### 1. DELUXE PACKAGE

All day freshly brewed Tea/Coffee,

**Morning & afternoon tea** with a selection from one of the following: Danish, Muffins and Biscuits.

#### **Lunch:**

**Option A:** A selection of fresh sandwiches, wraps, fruit platter and two different juices

**Option B:** Buffet style, a variety of cold meats, a selection of 4 fresh salads, Breadbasket and juice

**Option A - Lunch Deluxe Package \$33.00** per delegate

**Option B - Lunch Deluxe Package \$36.00** per delegate

### 2. STANDARD PACKAGE

All day freshly brewed Tea/Coffee, Morning **or** afternoon tea with a selection from one of the following: Danish, Muffins and Biscuits.

Buffet style, a variety of cold meats, a selection of 4 fresh salads, Breadbasket and juice

**\$28.00** per delegate

### 3. BASIC PACKAGE

All day freshly brewed Tea/Coffee, Morning **or** afternoon tea with a selection from one of the following: Danish, Muffins and Biscuits.

A selection of fresh sandwiches, wraps, fruit platter and two different juices

**\$24.00** per delegate

#### **4. Morning or Afternoon Tea**

Tea/Coffee, Morning **or** afternoon tea with a selection from one of the following: Danish, Muffins and Biscuits.

**Tea & Coffee only \$5.00** per delegate